

411086. BUFFER EVA / PE / PVC

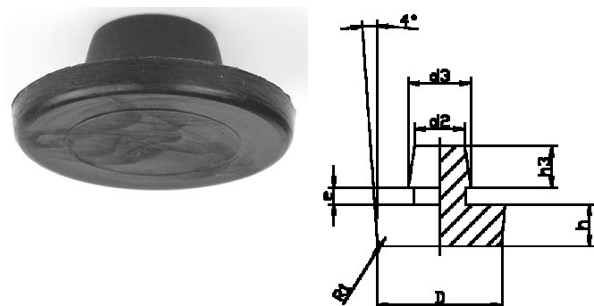

| Artikelcode | d2 | d3 | D | h | h3 | e | Materiaal |
|----------------------|-----|-----|------|-----|-----|-----|-----------|
| 411086.030080205.000 | 2,5 | 3,5 | 8,0 | 2,5 | 5,0 | 2,0 | EVA |
| 411086.030100205.000 | 2,5 | 3,5 | 10,0 | 2,5 | 5,0 | 2,0 | EVA |
| 411086.040080205.000 | 3,0 | 4,5 | 8,0 | 2,5 | 5,0 | 2,0 | EVA |
| 411086.050080205.000 | 5,0 | 6,5 | 8,0 | 2,5 | 5,0 | 2,0 | EVA |
| 411086.055130200.000 | 5,0 | 6,0 | 13,0 | 5,2 | 5,0 | 2,0 | PE |
| 411086.060100205.000 | 5,0 | 6,5 | 10,0 | 2,5 | 5,0 | 2,0 | EVA |
| 411086.060100206.000 | 5,0 | 6,5 | 10,0 | 2,5 | 5,0 | 2,0 | PE |
| 411086.060120210.000 | 5,8 | 6,5 | 12,0 | 4,6 | | 2,1 | PVC |
| 411086.060150150.000 | 4,0 | 6,0 | 15,0 | 5,0 | 5,0 | 1,5 | PVC |
| 411086.060150200.000 | 5,0 | 6,5 | 15,0 | 5,0 | 5,0 | 2,0 | EVA |
| 411086.060150206.000 | 5,0 | 6,5 | 15,0 | 5,0 | 5,0 | 2,0 | PE |
| 411086.067106070.000 | 6,5 | 7,5 | 10,6 | 8,1 | 3,9 | 2,0 | PVC |
| 411086.070100200.000 | 6,0 | 7,3 | 10,0 | 5,0 | 5,0 | 2,0 | EVA |
| 411086.070100200.004 | 6,0 | 7,3 | 10,0 | 5,0 | 5,0 | 2,0 | EVA |
| 411086.070100205.000 | 6,0 | 7,3 | 10,0 | 2,5 | 5,0 | 2,0 | EVA |
| 411086.070100206.000 | 6,0 | 7,3 | 10,0 | 5,0 | 5,0 | 2,0 | PE |
| 411086.070100207.000 | 6,0 | 7,3 | 10,0 | 2,5 | 5,0 | 2,0 | PE |
| 411086.070150200.000 | 6,0 | 7,3 | 15,0 | 5,0 | 5,0 | 2,0 | EVA |
| 411086.070150205.000 | 6,0 | 7,3 | 15,0 | 2,5 | 5,0 | 2,0 | EVA |
| 411086.070150206.000 | 6,0 | 7,3 | 15,0 | 5,0 | 5,0 | 2,0 | PE |
| 411086.070150207.000 | 6,0 | 7,3 | 15,0 | 2,5 | 5,0 | 2,0 | PE |
| 411086.070150210.000 | 6,0 | 7,3 | 15,0 | 3,5 | 5,0 | 2,0 | EVA |
| 411086.070150210.906 | 6,0 | 7,3 | 15,0 | 3,5 | 5,0 | 2,0 | EVA |
| 411086.070200200.000 | 6,0 | 7,3 | 20,0 | 5,0 | 5,0 | 2,0 | EVA |
| 411086.070200206.000 | 6,0 | 7,3 | 20,0 | 5,0 | 5,0 | 2,0 | PE |

| Artikelcode | d2 | d3 | D | h | h3 | e | Materiaal |
|----------------------|------|------|------|-----|-----|-----|-----------|
| 411086.070220200.000 | 6,0 | 7,3 | 22,0 | 5,0 | 5,0 | 2,0 | EVA |
| 411086.070220206.000 | 6,0 | 7,3 | 22,0 | 5,0 | 5,0 | 2,0 | PE |
| 411086.070250200.000 | 6,0 | 7,3 | 25,0 | 5,0 | 5,0 | 2,0 | EVA |
| 411086.070250206.000 | 6,0 | 7,3 | 22,0 | 5,0 | 5,0 | 2,0 | PE |
| 411086.080130159.000 | 7,5 | 8,5 | 13,0 | 4,0 | 5,0 | 2,0 | PAGV |
| 411086.080130200.000 | 8,5 | 9,5 | 13,1 | 4,5 | 5,0 | 2,0 | PE |
| 411086.080150200.000 | 7,0 | 8,5 | 15,0 | 5,0 | 5,0 | 2,0 | EVA |
| 411086.080150206.000 | 7,0 | 8,5 | 15,0 | 5,0 | 5,0 | 2,0 | PE |
| 411086.080200200.000 | 7,0 | 8,5 | 20,0 | 5,0 | 5,0 | 2,0 | EVA |
| 411086.080200206.000 | 7,0 | 8,5 | 20,0 | 5,0 | 5,0 | 2,0 | PE |
| 411086.080220200.000 | 7,0 | 8,5 | 22,0 | 5,0 | 5,0 | 2,0 | EVA |
| 411086.080220205.000 | 7,0 | 8,5 | 22,0 | 2,5 | 5,0 | 2,0 | EVA |
| 411086.080220206.000 | 7,0 | 8,5 | 22,0 | 5,0 | 5,0 | 2,0 | PE |
| 411086.080220207.000 | 7,0 | 8,5 | 22,0 | 2,5 | 5,0 | 2,0 | PE |
| 411086.080250200.000 | 7,0 | 8,5 | 25,0 | 5,0 | 5,0 | 2,0 | EVA |
| 411086.080250206.000 | 7,0 | 8,5 | 22,0 | 5,0 | 5,0 | 2,0 | PE |
| 411086.090220200.000 | 8,0 | 9,0 | 22,0 | 5,0 | 5,0 | 2,0 | EVA |
| 411086.090250200.000 | 8,0 | 9,0 | 25,0 | 5,0 | 5,0 | 2,0 | EVA |
| 411086.100150200.000 | 9,0 | 10,5 | 15,0 | 5,0 | 5,0 | 2,0 | EVA |
| 411086.100150206.000 | 9,0 | 10,5 | 15,0 | 5,0 | 5,0 | 2,0 | PE |
| 411086.100200200.000 | 9,0 | 10,5 | 20,0 | 5,0 | 5,0 | 2,0 | EVA |
| 411086.100200206.000 | 9,0 | 10,5 | 20,0 | 5,0 | 5,0 | 2,0 | PE |
| 411086.100220200.000 | 9,0 | 10,5 | 22,0 | 5,0 | 5,0 | 2,0 | EVA |
| 411086.100220206.000 | 9,0 | 10,5 | 22,0 | 5,0 | 5,0 | 2,0 | PE |
| 411086.100250200.000 | 9,0 | 10,5 | 25,0 | 5,0 | 5,0 | 2,0 | EVA |
| 411086.100250206.000 | 9,0 | 10,5 | 25,0 | 5,0 | 5,0 | 2,0 | PE |
| 411086.110150200.000 | 10,0 | 12,0 | 15,0 | 5,0 | 5,0 | 2,0 | EVA |
| 411086.110150205.000 | 10,0 | 12,0 | 15,0 | 2,5 | 5,0 | 2,0 | EVA |
| 411086.110150206.000 | 10,0 | 12,0 | 15,0 | 5,0 | 5,0 | 2,0 | PE |
| 411086.110150207.000 | 10,0 | 12,0 | 15,0 | 2,5 | 5,0 | 2,0 | PE |
| 411086.110200200.000 | 10,0 | 12,0 | 20,0 | 5,0 | 5,0 | 2,0 | EVA |
| 411086.110200206.000 | 10,0 | 12,0 | 20,0 | 5,0 | 5,0 | 2,0 | PE |
| 411086.110220200.000 | 10,0 | 12,0 | 22,0 | 5,0 | 5,0 | 2,0 | EVA |
| 411086.110220200.001 | 10,0 | 12,0 | 22,0 | 5,0 | 5,0 | 2,0 | EVA |
| 411086.110220205.000 | 10,0 | 12,0 | 22,0 | 2,5 | 5,0 | 2,0 | EVA |
| 411086.110220206.000 | 10,0 | 12,0 | 22,0 | 5,0 | 5,0 | 2,0 | PE |
| 411086.110220207.000 | 10,0 | 12,0 | 22,0 | 2,5 | 5,0 | 2,0 | PE |
| 411086.110250200.000 | 10,0 | 12,0 | 25,0 | 5,0 | 5,0 | 2,0 | EVA |
| 411086.110250206.000 | 10,0 | 12,0 | 22,0 | 5,0 | 5,0 | 2,0 | PE |